



HYDROBLOC-CJ7

Metal Plate Water-stop

Product Description:

HYDROBLOC-CJ7 is a high-performance metal plate water-stop system designed for waterproofing of construction joints in reinforced concrete structures. It consists of a galvanized iron (GI) steel plate (1.2 mm thick, 150 mm wide / 6 inches, 2 m length), factory-coated with:

- A bonding primer layer for enhanced adhesion
- A flexible ribbed coating based on Addiflex CSH technology, ensuring superior mechanical interlock and chemical bonding with fresh concrete

The system acts as a physical and active barrier, preventing water ingress through construction joints by extending the seepage path and ensuring monolithic bonding with concrete.

Key Features & Benefits:

- Acts as a continuous impermeable barrier at construction joints
- Dual action system – physical barrier + bonded interface sealing
- Extends seepage path, reducing water ingress
- Minimizes voids and debonding at joint interface
- High tensile strength GI steel – maintains shape during concreting
- Resistant to displacement and deformation
- Suitable for high hydrostatic pressure (positive & negative)
- Corrosion and chemical resistant (galvanized + coated)
- Long service life (≥ 50 years)
- Faster application vs conventional PVC water-stops

Areas Of Application:

Construction joints in:

- Basements & foundations
- Water tanks & reservoirs
- STP / ETP structures
- Tunnels & substructures
- Retaining walls
- Lift pits & underground slabs

Suitable for:

- Positive and negative water pressure
- High hydrostatic pressure conditions
- Critical waterproofing zones

Surface Preparation:

Reinforcement must be properly fixed and aligned. Construction joint area should be clean and free from debris. Ensure clear access along the joint line for proper placement. Verify joint location and alignment before installation



HYDROBLOC-CJ7

Application Guidelines:

- Place Hydrobloc CJ7 centrally along the construction joint.
- Ensure minimum embedment of 30 mm into concrete on both sides
- Fix to reinforcement using GI binding wire, or special fixing clips
- Ensure proper alignment (no waviness) and continuous placement along the joint
- Overlap adjacent plates by minimum 50–75 mm
- Seal overlaps using Addiflex coating touch-up, or compatible sealants
- Cast concrete ensuring proper vibration and ensure no voids are around the plate
- Ensure exposed coating is clean and intact. Remove any protective film (if applicable)
- Pour concrete ensuring full encapsulation of ribbed coating
- Ensure correct positioning at joint centerline
- Avoid displacement during pouring
- Ensure proper compaction (critical for performance)
- Do not damage coating during handling

Note: Improper fixing and poor compaction are primary causes of water-stop failure in concrete systems

- Not suitable for expansion joints (use flexible Hydrobloc EXPJ12)
- Requires proper concrete compaction for performance
- Overlaps must be properly sealed

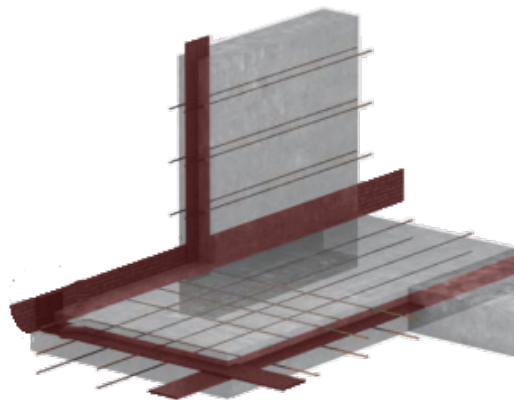

Refer to the image above for horizontal and vertical application of the Joint Sheet.

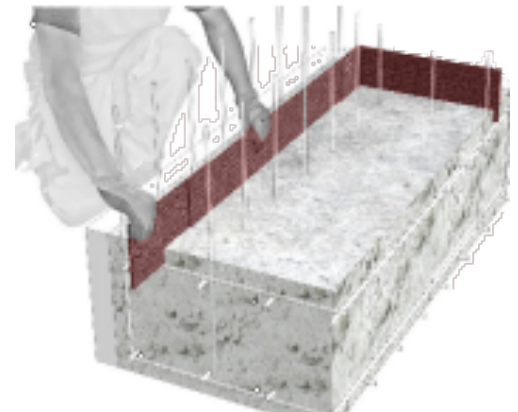

Refer to the image above for installation in wet concrete.



HYDROBLOC-CJ7

- In the case of rounded parts and corner constructions, simply bend the HYDROBLOC-CJ7 into the corresponding shape.



Refer to the image on the right for corner parts.

- Refer to the images below for the application of both omega clips and clips on the joint sheet.

*Refer to the images below for the application of both omega clips and clips on the joint sheet.

Holding Omega Clip:

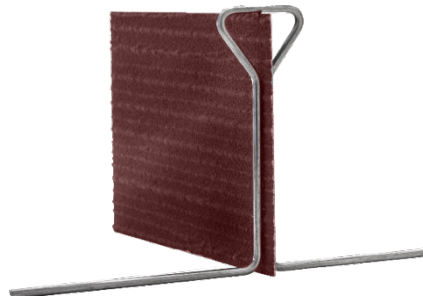

Overlap Clip:



Packaging:

Supplied in bundles. Standard size is 150mm width x 2m length.

Storage & Shelf life:

Unlimited storage period in dry, frost-free environment, protected from weather influences. Avoid damage to coating. Keep away from oil, grease and contaminants.

Health & Safety:

Non-toxic material, safe for general construction. Use gloves when handling to avoid cuts as edges may be sharp. Follow standard construction safety practices.





HYDROBLOC-CJ7

Technical Data:

Property	Value
Material	Galvanized Iron (GI Sheet)
Thickness	1.2 mm
Width	150 mm (6 inches)
Length	2 meters
Coating Type	Addiflex CSH Flexible Ribbed Coating
Coating Function	Adhesion + Mechanical Interlock
Tensile Strength (Typical Steel)	~515 MPa
Yield Strength	~205 MPa
Corrosion Protection	Zinc Galvanization + Coating
Service Life	≥ 50 years (installed condition)